

Hvidovre Hospital

Innovative Patient Information

www.triagonal.dk

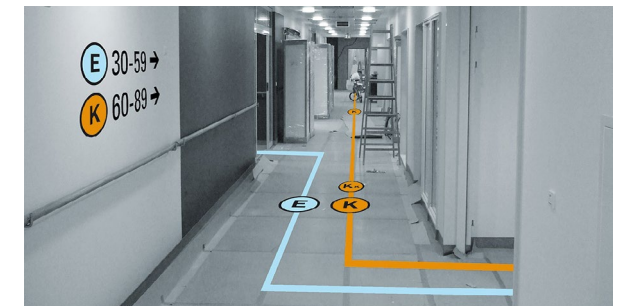
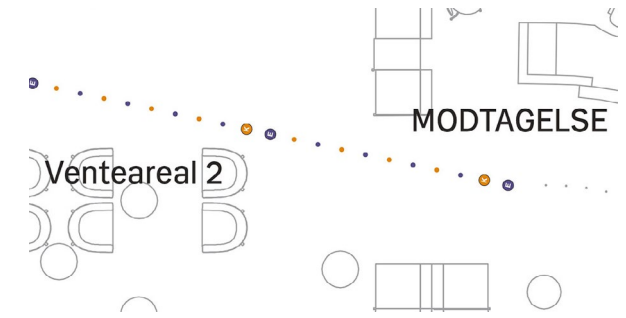

When three gastroenterological outpatient clinics were combined into one, Hvidovre Hospital wanted to improve the patient flow in their new physical environment. Based on user studies, Triagonal designed a wayfinding strategy which involved a patient information device, wayfinding graphics, and a completely new process for finding your consultation room.

Client	Hvidovre Hospital
Location	Hvidovre , Denmark
Project Period	2014
Team	Christian Karlsmose Peter Donner